

# drone

complex data acquisition

[marcviader@dronefutura.com](mailto:marcviader@dronefutura.com) +34610733994

# SUSPENDED PARTICLES AND URBAN DESIGN CRITERIA

High resolution measurement of respiratory health and geospatial information for newborns and young children in smarter cities















# Smart Citizen Kit

## Urban monitoring

ENVIRONMENTAL DATA

GET YOUR SMART CITIZEN KIT

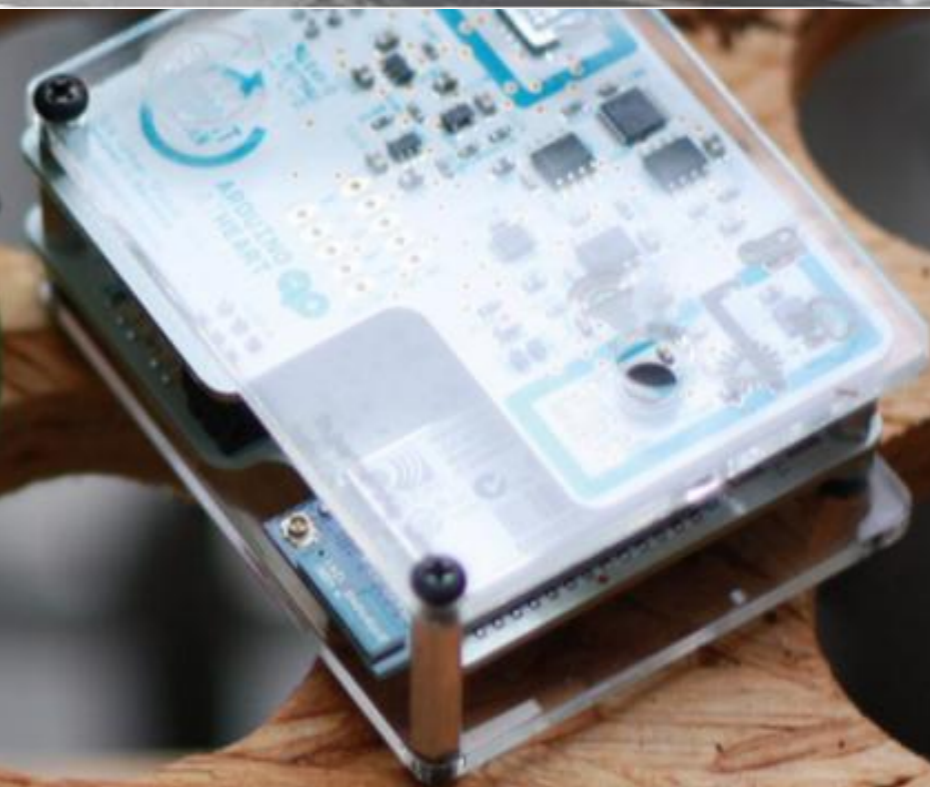

ARDUINO  
ATHEART 



# GOAL

- Just in order to ***improve the citizen's health***, we have been developing a tool to get high resolution and quality geospatial data at the small scale of suspended particles.



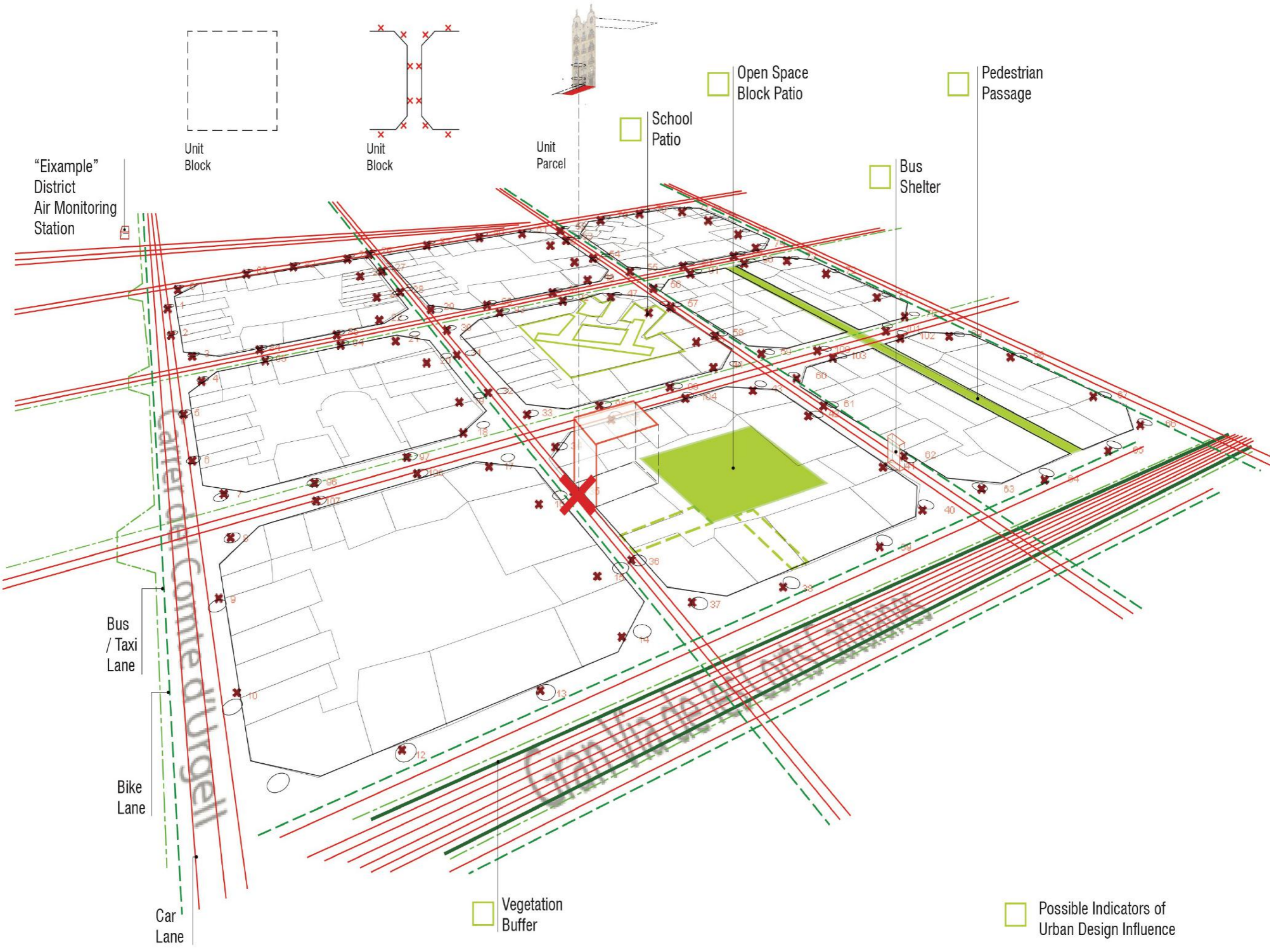

"Eixample"  
District  
Air Monitoring  
Station

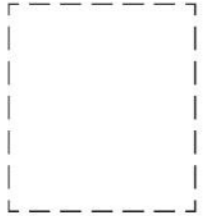

Unit  
Block

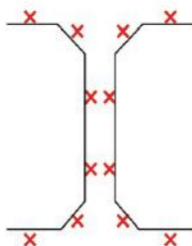

Unit  
Block

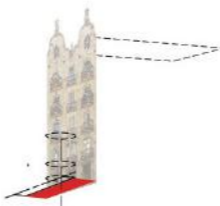

Unit  
Parcel



School  
Patio

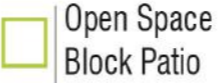

Open Space  
Block Patio

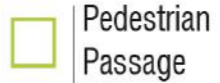

Pedestrian  
Passage



Bus  
Shelter



Vegetation  
Buffer



Possible Indicators of  
Urban Design Influence

Bus  
/ Taxi  
Lane

Bike  
Lane

Car  
Lane

Carreier de Comerç d'Urgell



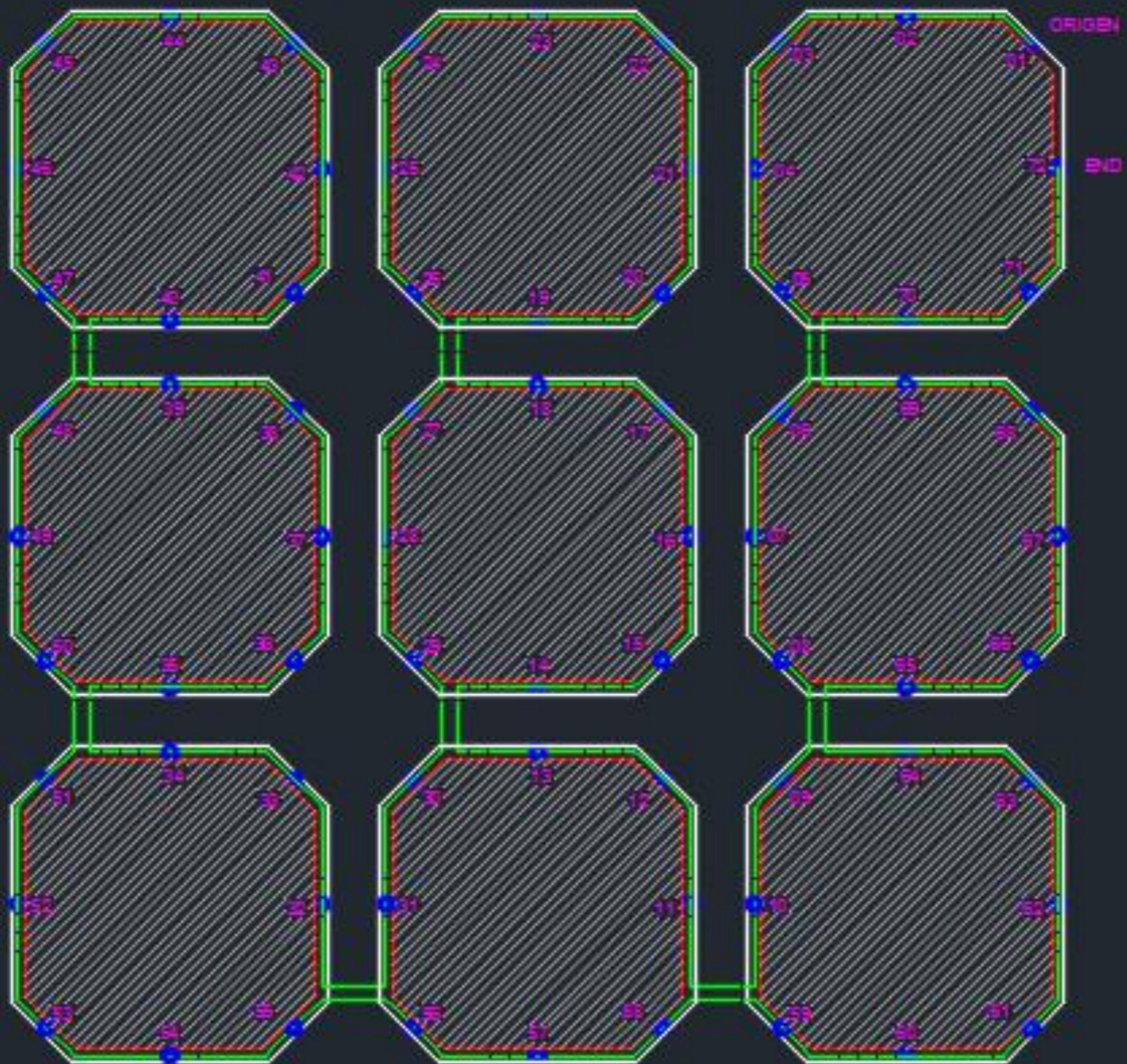

72 POIs = 72'

16 traffic lights = 16'

72 paths = 72'

TOTAL time = 160' = 2 hours and 40'



